

MAINTENANCE AND CARE MANUAL

CRUSAIDER ARMS

2022

TEMPLAR



1 TABLE OF CONTENTS

Templar 5.56 Semi Auto



WARRANTY AND GENERAL TEMPLAR QUESTIONS

Should you experience any issues using or assembling your Crusader Arms firearm. Or if you just have a general question.

Please do not hesitate to contact us:
Service Dept:
Service@spectreltd.ca

General Questions:
Crusaderarmscompany@gmail.com

We are always glad to help out our Crusader Arms family.

- Warnings/Cautions/Safe Handling
- Dangerous Procedures
- About Your Crusader Firearm
- Firearm Features & Controls – Identification/Location
- Clearing Your Firearm
- Preventative Maintenance Checks
- Safety Function Check
- Preparing to Fire / Loading a Magazine
- Operation of Your Firearm/Loading
- Operation/Inserting a Magazine
- Operation/Chambering from Open Bolt
- Operation/Chambering from Closed Bolt
- Operation/Stock Adjustments
- Immediate Actions – In Case of Trouble
- Remedial Actions
- Bullet Stuck in the Bore
- Disassembling Your Firearm
- Inspection/Cleaning/Lubrication
- Detailed Cleaning Techniques
- Cleaning the Upper Receiver
- Cleaning the Lower Receiver
- Cleaning the Bolt & Carrier
- Cleaning the Lower Receiver
- Reassembling Your Firearm
- Re-Configuring Firearm
- Parts and Accessories
- Warranty
- Contact information

2

PLEASE PRACTICE SAFE FIREARMS HANDLING



Templar 5.56 Semi Auto



WARNING: IF THIS FIREARM IS CARELESSLY OR IMPROPERLY HANDLED,

UNINTENTIONAL DISCHARGE COULD RESULT AND COULD CAUSE INJURY, DEATH, OR DAMAGE TO PROPERTY.

CAUTION: CAREFULLY READ THIS INSTRUCTION MANUAL PRIOR TO LOADING AND FIRING THIS FIREARM. FOLLOW ALL INSTRUCTIONS ON THE PROPER HANDLING AND SAFE USE OF THIS FIREARM - LIVES MAY DEPEND ON IT!

CAUTION: USE ONLY CLEAN, DRY, HIGH QUALITY COMMERCIALY MANUFACTURED

AMMUNITION IN GOOD CONDITION which is appropriate to the 5.56mm NATO/223 Remington or 6.8mm Remington SPC caliber of your Firearm. Crusader Arms does not recommend the use of remanufactured or hand loaded ammunition because it may damage your rifle and/or cause your firearm to malfunction.

WARNING: THIS FIREARM COULD CHAMBER A ROUND if it is dropped or jarred with a loaded magazine in place - either with the Bolt Carrier Assembly locked to the rear, or in its forward position.

RULES FOR SAFE GUN HANDLING



- ALWAYS KEEP THE FIREARM POINTED IN A SAFE DIRECTION.
- NEVER LOAD THE FIREARM UNTIL READY TO USE.
- KEEP YOUR FINGER OFF THE TRIGGER UNTIL READY TO SHOOT.
- **WARNING: BEWARE OF DANGEROUS PROCEDURES**
- When using a **Blank Firing Attachment**, NEVER FIRE ANYTHING EXCEPT BLANKS! For your safety, we recommend the visible, military style blank firing attachment (BFI Part# RAY-008).
- If your firearm stops firing with a live round in the chamber of a hot barrel (a misfire), **REMOVE THE ROUND FAST!** However, if you cannot remove it within 10 seconds, remove magazine and wait 15 minutes **with the Firearm pointing in a SAFE DIRECTION.** (*i.e. the round detonating just from the heat of the barrel*). Keep your face away from the ejection port while clearing a hot chamber.
- If your bolt fails to unlock, and you try to free it by tapping the buttstock on the ground while pulling on the charging handle, **keep yourself clear of the Muzzle and the Firearm pointed down range**
- If there is water in the barrel, do not fire the rifle. **IT COULD MALFUNCTION CAUSING PROPERTY DAMAGE, PERSONAL INJURY OR DEATH.**
- Pull the charging handle to the rear to break the seal to ensure the water will run off from the chamber through the ejection port area.
- If a noticeable difference in sound or recoil is experienced, **STOP FIRING!** Either condition could indicate an incomplete powder burn and/or a bullet or other obstruction stuck in the bore.
- Take the Firearm to a qualified gunsmith and have obstructions removed.



NOTE: With the Bolt Carrier Assembly locked to the rear, or in its forward position, if the Firearm is dropped or jarred with a loaded magazine in place, a live round could be chambered.

3

ABOUT YOUR Crusader RIFLE...

Templar 5.56 Semi Auto



All models feature vertical pistol grips and detachable magazines. Magazine capacity is 30 rounds standard (depending on Country/State/province Regulations), but all AR-15/M-16 type magazines of capacities from 5 to 40 rounds will fit the Templar and function in it. *GEN2 Mags are not recommended*

This Operating Manual covers the **Crusader Templar** which is chambered in 5.56mm NATO/223 Remington ammunition.

It is a gas piston, air-cooled shoulder fired, magazine fed Firearm, that is **Semi-Automatic** in operation (i.e., a single round will fire each time the trigger is pulled).

The templar Barrels are button pulled and hold the tightest tolerance allowed. They are rifled with either a 1 turn in 7" for heavier grain weight bullets or 1 turn in 8" for lighter bullets with a right-hand twist—6 lands and grooves.

The Templar is operated by a regulated, short-stroke Gas Piston System which eliminates hot gas from being in-traduced into the Upper.

The Templar Upper and Lower Receivers are easily opened for cleaning and inspection

The Upper Receiver is made of extruded Aluminum, the Lower Receiver is made of a 60610 T6 Aluminum.

The Bolt Group locks into the Barrel Extension with 7 locking lugs.

All models can be configured with either an AR 15 style stock or 7 position Telescoping/Folding Stock. Manufactured by F5.

Clearing your firearm

Always follow the rules of safe firearms handling.

First assume the firearm you are handling is loaded, and then proceed dash according to the following steps – to **clear your firearm**

1. Point firearm in a **safe direction!** Please safety selector lever on safe.
Note: if the firearm is not cocked, the safety selector lever cannot be pointed towards safe.
2. Press magazine release button an pull magazine down.
3. To lock hold open pull charging handle rearwards, press downwards on the external bolt catch lever, allow bolt to move forward until it engages the bolt catch. If you haven't before, now place the safety selector lever on safe.
4. visually and physically check that the chamber is clear

ALWAYS PRACTICE SAFE FIREARMS HANDLING



4

PREVENTATIVE MAINTENANCE CHECKS & SERVICE

Templar 5.56 Semi Auto



Always follow the rules of safe firearms.

First assume the firearm you are handling is loaded and then proceed according to the following steps to clear your firearm
Once Cleared, proceed.

1. Check to see that there is no excessive oil in the bore.
2. If excessive oil is present, swab it out with the patch and the cleaning rod. Always clean a new firearm before firing.
3. **Warning!**  If the firearm is fired with oil - or water - in the barrel, excessive pressure will be created and the firearm could malfunction causing personal injury, property damage or death.
4. Retract the bolt to ensure free movement
5. perform safety function check (next page) to ensure that safety selector lever.
6. ensure gas valve is tightened properly to 4 pounds of pressure

Lubricating your firearm

Always follow the rules of safe firearms handling.

Always lubricate your firearm to ensure free movement of all parts and to ensure your rifle will slide freely for many years to come

1. Always add some gun oil or lubrication to the charging handle slot prior to using.
2. Spraying or adding oil to the bolt, cam pin and recoil rods is always recommended.

Check before you fire!
Always follow the rules of safe firearms



5

SAFETY FUNCTION CHECK

Templar 5.56 Semi Auto



Always follow the rules of safe firearms.

unload firearm – remove magazine- Check chamber

1. Remove magazine if installed.
2. pull charging handle assembly to the rear, check the chamber is clear
3. let the bolt and bolt carrier close
4. do not pull trigger
5. leave hammer in cocked position
6. **Warning!** If the firearm fails any of the following tests, continued use of the firearm could cause malfunction causing personal injury, property damage or death.
7. Push selector lever in safe position, point the rifle in a safe direction, and pulled the trigger. the hammer should not fall.
8. Place selector lever in fire position. Pull trigger. **The hammer should not fall.**
 9. **Note:** For the purpose of the following check “slow” is defined as 1/4 to 1/2 the normal rate of trigger release
10. Hold trigger to the rear, pull charging handle to the rear and release charging handle. Then release pressure on the trigger with a slow, smooth, motion, without hesitations or stops, until the trigger is fully forward
 11. **An audible click should be heard, the hammer should not fall.**
12. Repeat the fire position test 5 times. The firearm must not malfunction during any of these five tests. Pull the charging handle to the rear one last time and release.
13. Place the selector lever in safe position. Pull the trigger. The hammer should not fall.



NOTE: If the firearm malfunctions during any of these five tests, have the firearm checked by a trained Gunsmith.

Preparing to fire- Loading Magazine

1. Use only quality ammunition in your firearm. Examine each cartridge particularly around the primer look for dents, scratches, and another signs of damage.



DO NOT LOAD DAMAGED AMMUNITION

2. With the magazine facing forward as shown in the illustration place around between the feed lips of the magazine with the bullet tip forward. push the round down until it is held by the magazine feed.
3. If necessary, give the round a slight push backward to seated against the inside back edge of the magazine feed lips. Place the next round on top of the previous round and repeat steps until desired number of rounds are loaded into the magazine.



Caution! safe firearm handling dictates that you **ONLY LOAD LIVE AMMUNITION INTO YOUR RIFLE WHEN YOU ARE ABOUT TO SHOOT.**

6

OPERATION OF YOUR FIREARM: - LOADING

Templar 5.56 Semi Auto



NOTE: Always point the muzzle in a safe direction.

1. With the hammer cocked place selector lever on **SAFE**.



2. Open Bolt and check Firing Chamber. Make sure it is CLEAR



INSERTING A MAGAZINE..

1. Return charging handle to forwarded locked position push magazine up into magazine well until magazine catch engages and holds the magazine.



2. It is not necessary to push the magazine in any further after the mag catch lever engages. It is recommended to pull downwards on the magazine to ensure the magazine is secured in the magwell .



7

CHAMBERING A ROUND FROM AN OPEN BOLT

Templar 5.56 Semi Auto



NOTE: The magazine may be inserted into the firearm with the bolt assembly open or closed.

Always point the muzzle in a safe direction.

1. There are two ways to close the action and chamber a round.
2. If the action is held open by the last round bolt catch lever, Make sure the charging handle is not in the locked open position(a). Push the bolt catch release lever **forward** (b). The bolt should spring forward, and this will chamber a round from the magazine.



3. When the action is held open by the charging handle, picture (c) is shown In the locked open position.,
4. Slap the charging handle down and allow the action to close the gun.

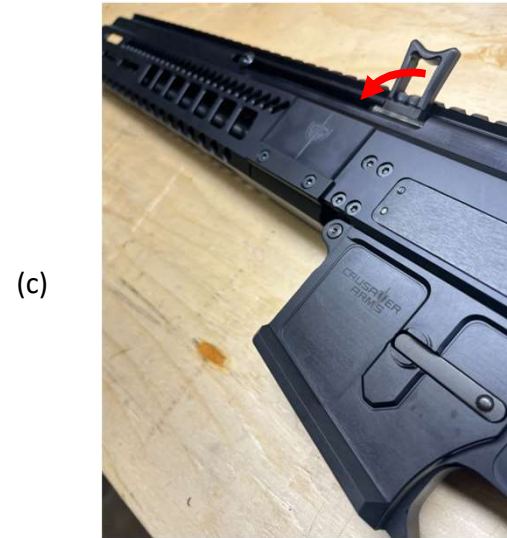

Pro Tip: Do not ride the the action closed slowly, a mis feed of the round might occur. The bolt requires spring pressure to close a round.

5. You may also pull the charging handle back and let it go **hard** again, do not ride charging handle forward.
6. **Firearm is now ready to be aimed and fired. Please handle safely.**

8

CHAMBERING A ROUND FROM AN CLOSED BOLT

Templar 5.56 Semi Auto



NOTE: The magazine may be inserted into the firearm with the bolt assembly open or closed.

Always point the muzzle in a safe direction.

1. With a magazine in the firearm pull the charging handle fully to the rear. *(at dashed line)*
2. release the charging handle allowing the bolt to spring forward chambering the 1st round. **Caution** Firearm is now ready to be aimed and fired.



NOTE: Note if firearm is not going to be fired immediately make sure the selector lever is on safe.

A round is chambered, and the safety selector should be on safe.

OPERATING THE FIREARM

To fire the firearm in semi automatic mode:

(one round fired with each pull of the trigger)

1. move the safety selector from safe to fire
2. Aim at target
3. Pull trigger
4. Release.

The firearm will automatically eject the spent casing and chamber another round, In preparation for the next shot.

The cycle of pulling the trigger to shoot the firearm, can be continued until the magazine is empty.

After the last round is fired, the bolt carrier will lock in the rear position.

1. push the magazine release button
2. empty magazine will drop
3. insert a fresh magazine
4. release the bolt catch *(see page 8 for Bolt Catch Release operation)*

A new round will automatically be chambered in the preparation for the next firing sequence



WARNING if a noticeable difference in sound or recoil is experienced stop firing and immediately check the firearm for obstructions an obstruction may cause a malfunction causing property damage personal injury or death. Either condition could indicate an incomplete powder burn end or a bullet stuck in the bore retract the bolt slowly and removed the fired casing clear the firearm and check for unburnt powder grains in the receiver or bore and four a bullet stuck in the bore clean out any unburnt powder before resuming firing if the bullet is stuck in the bore do not attempt to remove it take the firearm to a qualified gunsmith.

9

STOCK ADJUSTMENTS

Templar 5.56 Semi Auto



TO ADJUST THE CHEEK RISER PIECE HEIGHT:

1. Slide the cheek piece rear word.
2. Lift cheek piece to elevate position
3. Slide cheek piece forward to lock into place
4. reverse action in order to return cheekpiece to position



NOTE: stock is held open by D tent but does not lock closed.

NOTE: The firearm can be fired with the stock in the folded position with clearance for the ejecting cartridge.

OPTIONAL FOLDING TELESCOPING:

TO ADJUST THE LENGTH OF PULL:

1. Depress both left and right stock extension buttons
2. Slide stock forward or back.

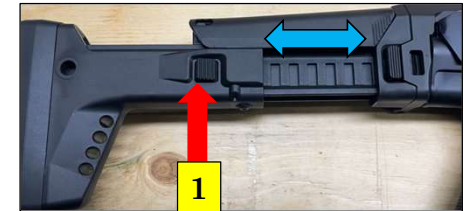

TO FOLD THE STOCK:

1. Depress the stock release latch
2. Fold the stock forward on the right-hand side
3. Return the stock
4. Pull to the rear until the stock locks into place

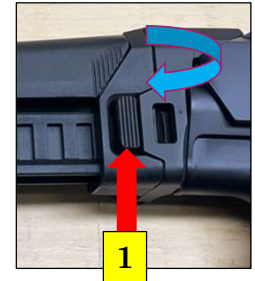

TO REMOVE THE STOCK FOR OPTIONAL BUFFER TUBE THREAD

1. When the stock is in the folded position.
2. Simply remove (1) ¼ screw with an Allen wrench. Slide adaptor and stock off lower.
3. The rear of the lower will show an optional Buffer tube. 1-3/16" - 16 UN



10

Immediate actions – In case of trouble

Templar 5.56 Semi Auto



If your firearm stops firing- Perform the following **immediate actions** remember the word **SPORTS**

1. Slight push and pull down on the magazine to ensure a good lock up in lower receiver
2. Pull the charging handle all the way back and hold
3. Observe the ejection of the case or cartridge check chamber for obstructions
4. Release the charging handle and let the bolt spring forward
5. Tap the charging handle to assist the bolt forward to ensure the bolt is locked
6. Squeeze the trigger to fire

Remedial actions

 **Warning** if your firearm stops firing with a live round in the Chamber of a hot barrel. Remove the round immediately, however if you cannot remove it within 10 seconds, remove the magazine and wait 15 minutes with the firearm pointing in a safe direction. (always check that the safe direction remains safe during that time) This way you and those around you won't get hurt by the possibility of a round "cooking off"

KEEP YOUR FACE AWAY FROM THE EJECTION PORT WHILE CLEARING A HOT FIREARM

Remedial actions

1. if your firearm still fails to fire after performing immediate actions steps one through 5 on previous page check again for a jammed cartridge casing.
2. If a cartridge casing is in the chamber open the receiver remove the bolt carrier and try to tap out the casing with a cleaning rod.

If firearm still fails to fire check the troubleshooting section in this manual or take the firearm to a qualified Gunsmith.



Bullet stuck in bore

Warning if an audible "pop" or reduced recoil is experienced during firing, immediately cease fire then,

1. Remove the magazine.
2. Lock the bolt to the rear.
3. Place the selector lever on safe.
4. Visually inspect end or insert a cleaning rod into the bore to ensure there is not a bullet stuck in the bore



DO NOT APPLY the immediate actions described on previous pages if a bullet is stuck in the barrel of the firearm do not try to remove it take the firearm to a qualified gunsmith.



11

DISASSEMBLY OF YOUR FIREARM

Templar 5.56 Semi Auto



**CLEAR YOUR FIREARM AS DESCRIBED ON PAGE 6.
ALWAYS WEAR SAFETY GLASSES.**

1. Push the charging handle fully forward to disconnect the actuator from the bolt carrier and also it will relieve spring pressure. *(image1)*

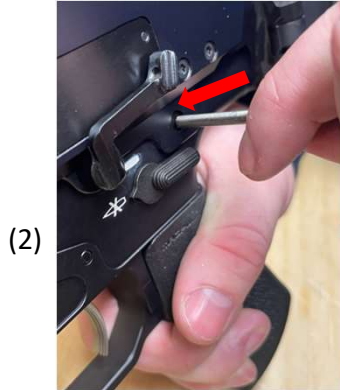

2. Push in the rear takedown pin with a .250" diameter punch or smaller, as far as it will go* *(image2)*

*Note pivot pin in the lower receiver and takedown pin in the lower receiver are captive, meaning that they are held in by their detents and springs so they cannot fall out and get lost.

3. Push the rear takedown plate forward. A punch inserted from the top can help in this procedure.



4. Pivot the upper receiver from the lower receiver.

Note: As shown in figure (C), keep a finger on the rear take down plate to prevent popping out, as it will still be under slight spring pressure when you pivot open the gun.



12

DISASSEMBLY OF YOUR FIREARM

Templar 5.56 Semi Auto



5. Push the charging handle fully forward to disconnect the actuator from the bolt carrier

6. Remove the bolt carrier and recoil rod assembly to the rear.



7. You can now use a punch or bullet tip to push the front take down pin out the same as in the procedure used on the rear takedown pin.



8. The upper receiver should now be completely removed from the lower.

Disassemble your bolt Carrier group

1. Remove firing pin retaining pin
 2. Remove cam pin by turning bolt carrier on its side and tapping opposite side of the bolt carrier Cam pin should fall out.
 3. Remove firing pin end spring out of the rear of the bolt carrier
 4. Remove bolt from bolt carrier by pulling straight out
- disassemble using steps 5 and 6 only when dirty or damaged
5. Remove extractor pin by pushing out with a punch or the tip of a bullet
 6. Remove extractor with spring

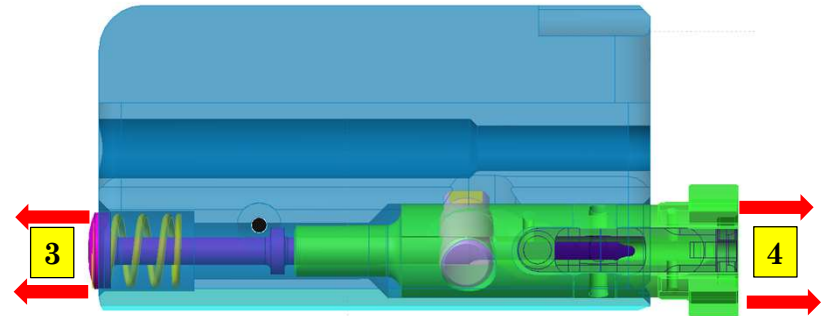
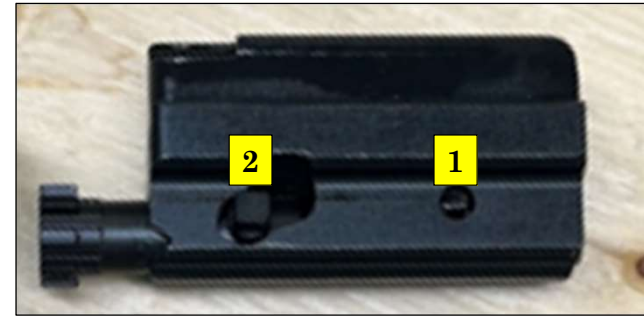

Note press rear of extractor to check spring function 
Caution extractor spring may pop out and get lost.

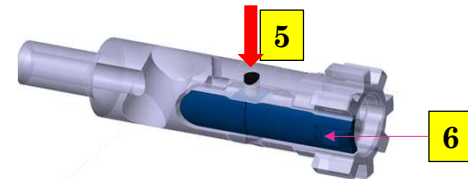

13

DISASSEMBLY OF THE GAS PISTON SYSTEM

Templar 5.56 Semi Auto



1. With a 3/8 socket turn gas valve counter clockwise until it is free
2. Pull gas valve out
3. Remove piston rod and piston spring through the front of the gas block

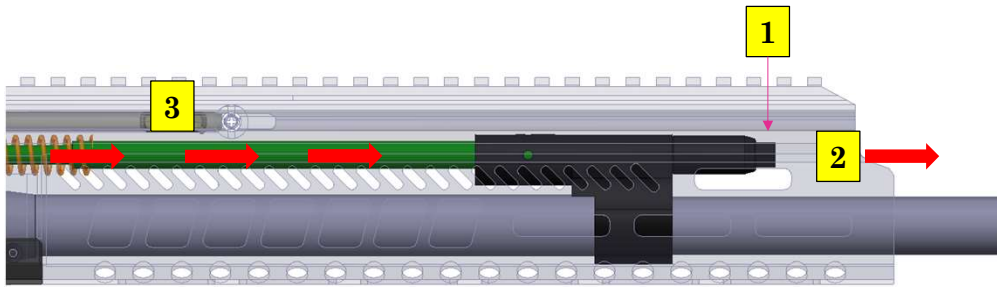

Crusader Arms does not recommend any further disassembly any further disassembly must be performed by a qualified gunsmith.

Warranty is void if further dis-assembly is performed unless performed by a qualified gunsmith.

RE- ASSEMBLY OF THE GAS PISTON SYSTEM

1. Insert piston rod and piston spring through the rear of the gas block. (the spring should already be on the piston before inserting).
2. To help contain and guide the spring, Insert a punch or any firearm assembly pin with a diameter of 1/4 or smaller from the inside if the upper receiver. This will prevent spring flexing as the piston and gas valve pin are inserted and fastened to the gas block.

Figure (a) below, insert the guide punch into the spring and meet the piston face to face with your guide punch as you are fastening the valve pin.

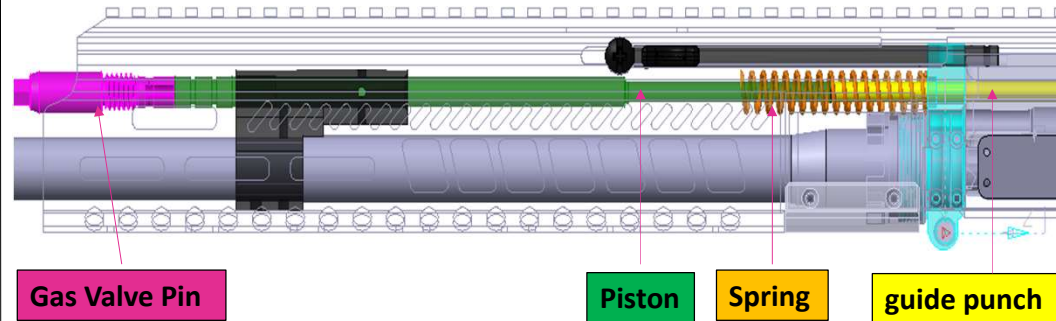

1. With a 3/8 socket turn gas valve clockwise until tight.

If you are unsure about the re-assembly of your firearm, Crusader Arms recommends you to take this firearm to a qualified gunsmith for review before you discharge your firearm.



13

ASSEMBLY OF THE BOLT CATCH RELEASE LEVER

Templar 5.56 Semi Auto



This next section will show you how to install your External bolt catch release lever.

It is recommended that you install this Lever with the hammer forward.

Image to the right shows the lever fully installed. Rendered Images below show certain parts removed just for clarity of the image.



Note: make sure spring is hooked over the safety. And the top is pointing As shown here. Step 1

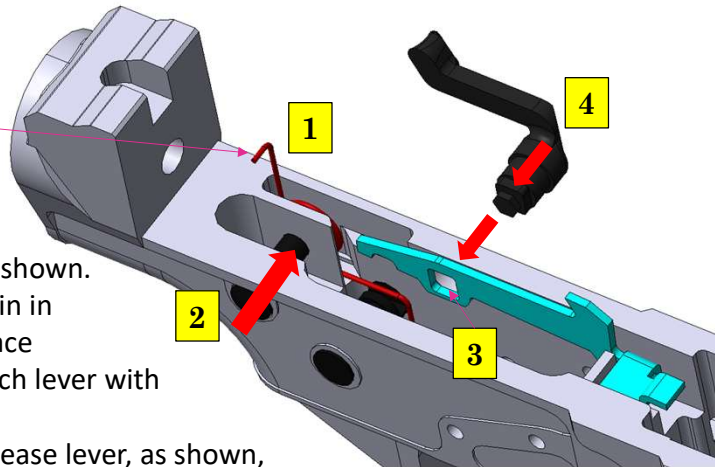

1. Put spring in pocket as shown.
2. Push rear take down pin in This will hold spring in place
3. Align square in bolt catch lever with hole in lower.
4. Push the Black steel release lever, as shown, through the lower and into the locating square on the internal bolt catch lever.

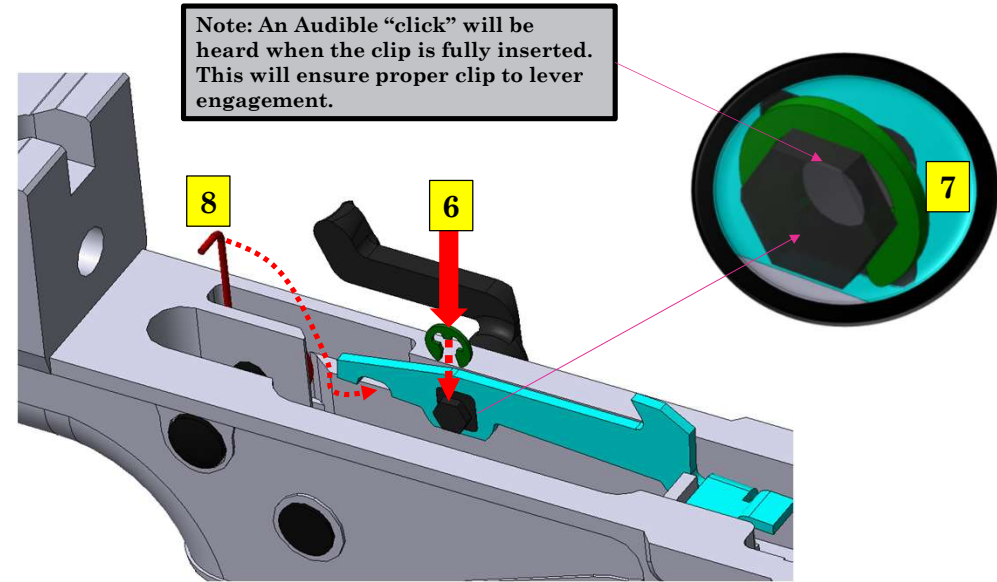

Note: An Audible "click" will be heard when the clip is fully inserted. This will ensure proper clip to lever engagement.

5. Make sure the Steel black external lever is flush with the outside of the lower.
 6. Insert the Retaining E-Clip down into the locating slot, as shown above.
 7. A small punch will be needed to push down and fully engage the E-clip over the mating shaft. **Note the audible "click" when the clip is fully engaged.**
 8. Using a pair of needle nose plyers, grab the end of the spring as shown above.
 9. Pull down and around the end of the release clip, resting the end of the spring into the mating slot on the internal bolt catch lever.
- Final assembly is shown below for reference.

Note: It is recommended to replace the E-Clip after each time the lever is removed and re-assembled to maintain full retaining strength.



13

AMBI CHARGE HANDLE: REMOVAL AND SWITCH SIDES

Templar 5.56 Semi Auto



This next section will show you how to remove your ambidextrous charging handle and install it on the opposite side of the firearm.



1. Relieve spring pressure
2. Open up firearm.

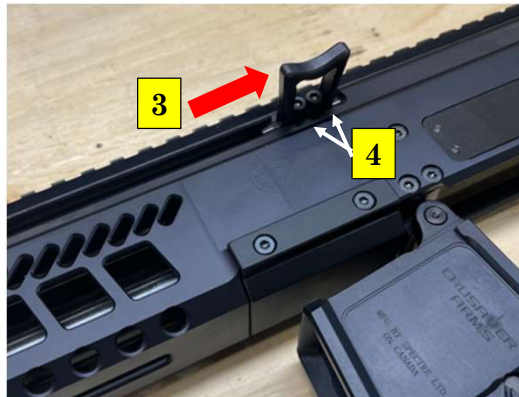

3. Slide Charging handle back As far as it can go.
4. Remove (2) 6-32 screws and Washers. Put charging handle, screws and washers aside for re-assembly.

AMBI CHARGE HANDLE: REMOVAL

5. From the inside of the firearm, slide the charging pin out from the Left hand side of the firearm and slide the charging pin in the corresponding slot, on the opposite side of the gun.



6. When re-inserting the charge pin, Ensure the ball detent is facing upwards As outlined and shown in figure (d).

7. Assemble the charge handle onto the Pin, it does not matter which way the Handle faces, it is the same on both sides.

8. Slide lock washers on to screws and Fasten the (2) 6-32 screws as shown.



9. Always apply a lubrication to your charge pin prior to stoking the action. 

14

INSPECTION — CLEANING — LUBRICATION...

Templar 5.56 Semi Auto



AFTER FIRING YOUR FIREARM, clean it as soon as possible to make the job easier and to avoid allowing the development of any corrosion.

WHEN YOUR FIREARM HAS NOT BEEN FIRED you should clean it at least once or twice a year if you live in a temperate climate, or as often as once a week in a tropical climate.

IF YOU GET YOUR FIREARM WET, clean it as soon as possible to avoid the onset of corrosion or rust.

Use a high-quality firearm cleaning kit that includes a cleaning rod; swab holder; cotton flannel bore patches; pipe cleaners; a small toothbrush; brass wire bristle bore and chamber brushes and a Cleaner, Lubricant, Preservative.

AFTER YOU HAVE DISASSEMBLED THE FIREARM, THOROUGHLY CLEAN, INSPECT AND LUBRICATE ALL PARTS.

CLEANING THE BORE: The bore of your Templar rifle has Lands and Grooves called rifling. Rifling makes the bullet spin very fast as it moves down the Bore and down range. It is difficult to push a new, stiff Bore Brush through the Bore. You will find it much easier, and more effective, to pull your Bore Brush through the Bore. Also, because the brush will clean better if the bristles follow the grooves (this is called tracking), you want the Bore Brush to be allowed to turn as you pull it through.

ALWAYS CLEAN FROM THE CHAMBER TOWARD THE MUZZLE.

Follow these steps:

1. Attach three Rod Sections together but leave each one about two turns short of being tight. Attach the Patch Holder but leave it two turns short of tight also.
2. Point Muzzle down. Hold the Upper Receiver or Barrel Assembly in one hand while inserting the end of the Rod with Patch Holder attached into the Chamber. Guide the Rod carefully through the Bore.
- CAUTION:** Do not let the Rod or its threaded end scratch the Lining of the Bore or Firing Chamber. About 2 - 3 inches of the Rod should protrude out of the Muzzle.
3. Attach the Handle Section of the Cleaning Rod to the end of the Rod sticking out of the Muzzle and swab out the Bore with a patch moistened with "CLP".
4. Remove Patch Holder and attach Bore Brush (leaving it two turns short of tight).
5. Pull the Brush through the Bore and out the Muzzle. You should be able to see the Rod twisting as you pull it - this is the Brush "tracking" in the rifling.

NEVER reverse the direction of the Bore Brush while it is in the Bore.

6. After one pull, take off the handle section and repeat the process. After three or four pulls, the three rod sections and the Bore Brush may become screwed tightly together. Loosen them up and repeat the process.
7. Send a patch through the Bore occasionally to help clean out the crud that the brush is getting loose. Just replace the Bore Brush with the Rod Tip (Patch Holder) and a wet patch. Pull it through. If you leave the rods loose again, the patch will "track" in the rifling as before. But remember, always have the Bore wet with cleaner before trying to pull a brush through.

15

INSPECTION — CLEANING — LUBRICATION...

Templar 5.56 Semi Auto



CLEANING THE UPPER & LOWER RECEIVER...

1. Using a“CLP” type product, clean all areas (inside and out) of Powder Fouling, Corrosion and Dirt.
Never use a wire brush or any type of abrasive to clean the Aluminum Upper or Lower Receiver or Guide Rod Rails - you'll scratch and damage the finish. A Toothbrush is good for loosening any dirt buildup and won't scratch the Receiver.
2. Wipe all components clean and dry, and inspect for excessive wear, corrosion or mechanical damage.

Have a qualified Gunsmith replace any worn or defective parts before firing again.



NOTE: When Cleaning the upper Receiver, please clean out the charging Handle slot.

ALWAYS LUBRICATE YOUR CHARGING HANDLE SLOT PRIOR TO CHARGING YOUR FIREARM.

CLEANING THE BOLT CARRIER GROUP...

1. Clean and inspect Bolt, Cam Pin, Firing Pin, Firing Pin Spring, Firing Pin Retaining Pin and Action Spring Assembly thoroughly.

CHECK THE BOLT: Look for cracks or fractures, especially in the Cam Pin hole area. Inspect Bolt Face - Bolts with any pitting extending into the firing pin hole should be replaced.

CHECK THE CAM PIN: If it is cracked, or chipped, it should be replaced.

NOTE: Cam Pin can only be installed in Bolt from one side - so Ejector will be positioned correctly.

CHECK THE FIRING PIN: If it is bent, cracked, too blunted or too sharp, it should be replaced.

CHECK THE FIRING PIN RETAINING PIN: If it is bent, or badly worn, it should be replaced.

WIPE ALL PARTS DRY BEFORE REASSEMBLING BOLT CARRIER.

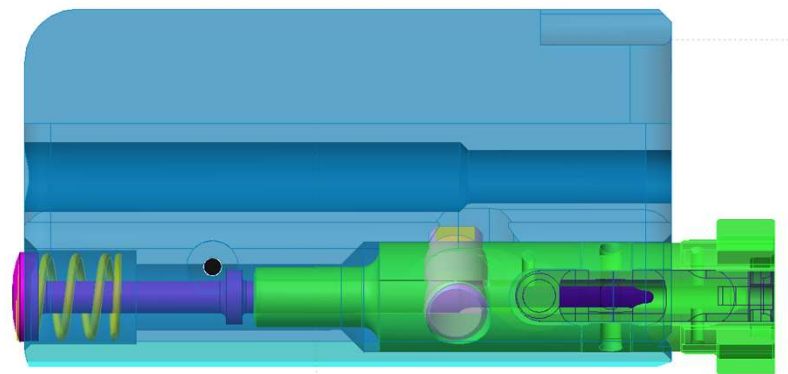

BOLT CARRIER GROUP

DETAIL VIEW

Templar 5.56 Semi Auto



1. F5 FOLDING STOCK
2. GUIDE ROD PLATE AND SPRINGS
3. STEEL SIDE PLATE
4. SHELL DEFLECTOR
5. STEEL FRONT TRUNNION
6. BARREL NUT
7. PISTON SPRING
8. PISTON
9. GAS BLOCK
10. GAS VALVE PIN
11. BARREL WITH FLASH HIDER
12. UPPER RECEIVER ALUMINUM
13. STEEL REAR TRUNNION
14. COVER PLATE
15. CHARGING PIN
16. CHARGING HANDLE
17. CHARGING PIN STOP PIN
18. EXTRACTOR AND PIN
19. CAM PIN

20. BOLT
21. BOLT CARRIER WITH COTTER PIN
22. FIRING PIN SPRING
23. FIRING PIN
24. FRONT TAKEDOWN PIN
25. FRONT TAKEDOWN PIN DETENT
26. FRONT TAKEDOWN PIN SPRING
27. TRIGGER GROUP
28. SAFETY SELECTOR LEVER
29. SAFETY SELECTOR DETENT SPRING
30. SAFETY SELECTOR DETENT
31. REAR TAKEDOWN PIN SPRING
32. SAFETY SELECTOR SHAFT
33. REAR TAKEDOWN PIN
34. PISTOL GRIP
35. REAR TAKEDOWN PIN DETENT
36. PISTOL GRIP SCREW
37. ALUMINUM LOWER RECEIVER
38. BOLT CATCH SPRING
39. BOLT CATCH RELEASE LEVER
40. E-CLIP
41. BOLT CATCH
42. MAG RELEASE BUTTON ASSEMBLY

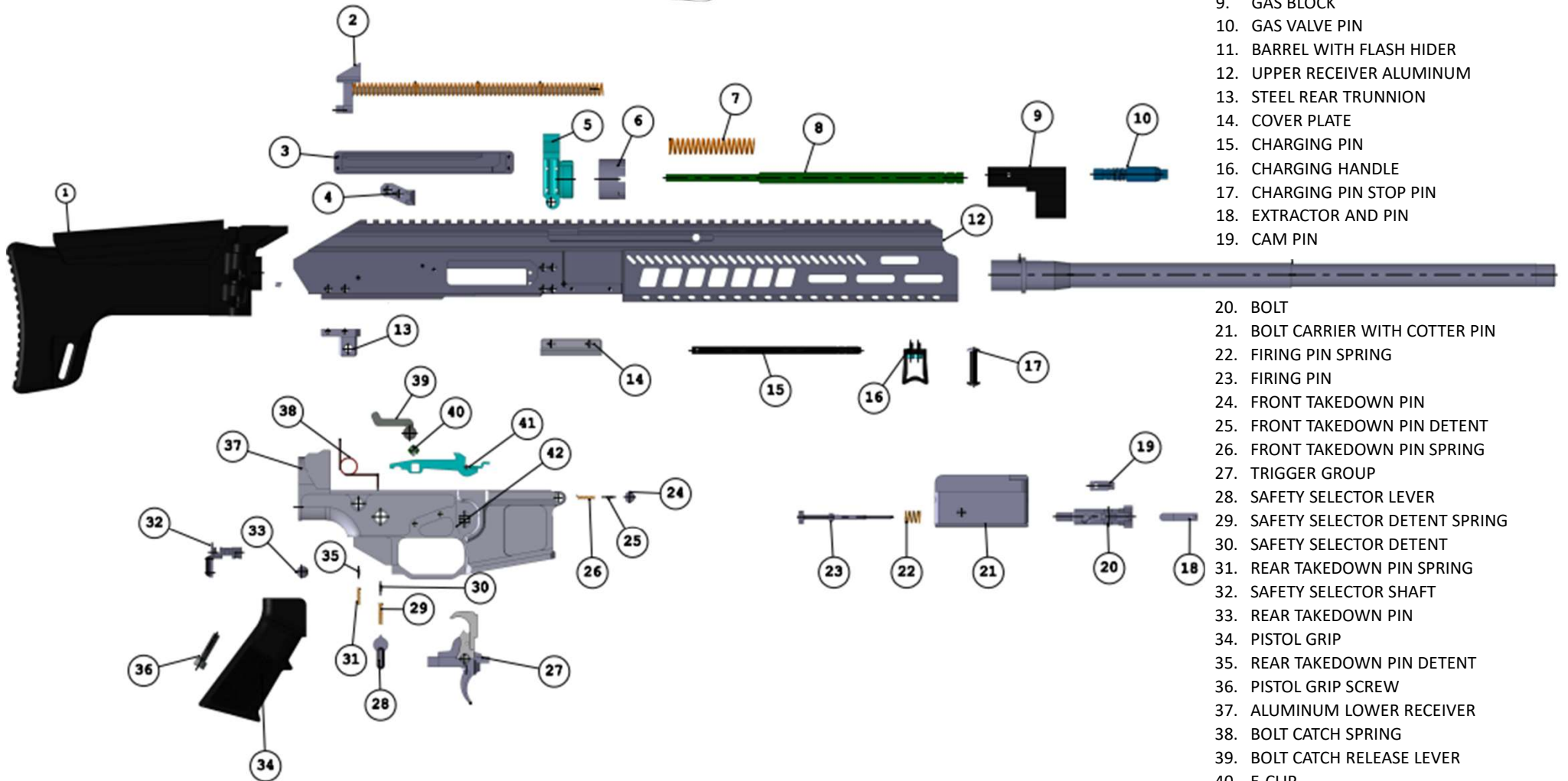

14

PLEASE PRACTICE SAFE FIREARMS HANDLING!



Templar 5.56 Semi Auto

WARNING: IF THIS FIREARM IS CARELESSLY OR IMPROPERLY HANDLED, UNINTENTIONAL DISCHARGE COULD RESULT AND COULD CAUSE PERSONAL INJURY, DEATH, OR DAMAGE TO PROPERTY.

CAUTION: CAREFULLY READ THIS INSTRUCTION MANUAL PRIOR TO LOADING AND FIRING THIS FIREARM. FOLLOW ALL INSTRUCTIONS ON THE PROPER HANDLING AND SAFE USE OF THIS FIREARM - LIVES MAY DEPEND ON IT!

CAUTION: USE ONLY CLEAN, DRY, HIGH QUALITY COMMERCIALY MANUFACTURED AMMUNITION IN GOOD CONDITION which is appropriate to the 5.56mm NATO/223Remington caliber of your firearm. CRUSADER ARMS does not recommend the use of remanufactured, or hand loaded ammunition because it may damage your rifle.

WARNING: THIS FIREARM COULD CHAMBER A ROUND if it is dropped or jarred with a loaded magazine in place - either with the Bolt Carrier Assembly locked to the rear, or in its forward position.

This TEMPLAR Operating and Safety Instruction Manual should always be kept with your TEMPLAR Firearm, and in case of sale or transfer, should be passed on to subsequent owners.

Model: _____

Serial _____

Number: _____

Sold _____

To: _____

Date _____

Sold: _____

Notes:
